



UtiliView

Application

Operator's Manual



Overview

Intended Use

The Subsite UtiliView mapping app is intended to be used in utility mapping applications. The app provides the user with the ability to send log points from the receiver to the user's Esri map. Attributes such as utility type, depth, and frequency are tied to each log point. A line between each log point is created with the distance between points also calculated. The app also has a feature called Point Navigation that allows a user to enter a previously located log point ID and navigate back to it.

The UtiliView app can be used with the Subsite® Utiliguard 2 Standard with 1.0.11-34 radio, Advanced with 1.0.11-34 radio, and RTK receivers with GNSS capabilities.

The UtiliView app should be operated only by persons familiar with its particular characteristics and acquainted with the relevant safety procedures.

California Proposition 65



Cancer, birth defects, and other reproductive harm. www.P65warnings.ca.gov.

Foreword

This manual is an important part of your equipment. It provides safety information and operation instructions to help maintain your Subsite equipment.

Read this manual before using your equipment. Keep it with the equipment at all times for future reference. If you sell your equipment, be sure to give this manual to the new owner.

If you need a replacement copy, contact your Ditch Witch dealer. If you need assistance in locating a dealer, visit our website at www.subsite.com, email info@subsite.com or write to the following address:

Subsite Electronics
ATTN: Product Support
1950 W. Fir
Perry, OK 73077-0066
USA

The descriptions and specifications in this manual are subject to change without notice. The Charles Machine Works, Inc. reserves the right to improve equipment. Some product improvements may have taken place after this manual was published. For the latest information on Subsite equipment, see your Ditch Witch dealer.

Thank you for buying and using Subsite equipment.

**UtiliView App
Operator's Manual**

Issue number 1.0/OM-10/2024

Part number 790-10007

Copyright 2024

by The Charles Machine Works, Inc.



Subsite and Ditch Witch are registered trademarks of The Charles Machine Works, Inc.

This product and its use may be covered by one or more patents at <http://patents.charlesmachine.works>.

Contents

Overview	1
Equipment serial number, information about the type of work this equipment is designed to perform, basic equipment components, and how to use this manual	
Foreword	3
Part number, revision level, and publication date of this manual, and factory contact information	
Safety	7
Equipment safety alerts and emergency procedures	
Prepare	11
Procedures for preparing jobsite, preparing operator, and preparing equipment	
Controls	19
Equipment controls and indicators and how to use them	
System Operation	35
Procedures for using the app	
Support	43
The warranty policy for this equipment and procedures for obtaining warranty consideration and training	

Safety

Chapter Contents

Safety Alert Classifications 8

Guidelines 9

Safety Alerts 10

Safety Alert Classifications

These classifications and the icons defined on the following pages work together to alert you to situations which could be harmful to you, jobsite bystanders, or your equipment. When you see these words and icons in the book or on the machine, carefully read and follow all instructions. **YOUR SAFETY IS AT STAKE.**



When you see this safety alert sign, carefully read and follow all instructions. **YOUR SAFETY IS AT STAKE.** Read this entire section before using your equipment.

Watch for the three safety alert levels: **DANGER**, **WARNING**, and **CAUTION**. Learn what each level means.



DANGER indicates a hazardous situation that, if not avoided, will result in death or serious injury. This signal word is to be limited to the most extreme situations.



WARNING indicates a hazardous situation that, if not avoided, could result in death or serious injury.



CAUTION indicates a hazardous situation that, if not avoided, could result in minor or moderate injury.

Watch for two other words: **NOTICE** and **IMPORTANT**.

NOTICE indicates information considered important, but not hazard-related (e.g., messages relating to property damage).

IMPORTANT can help you do a better job or make your job easier in some way.

Guidelines

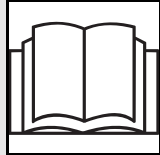

⚠ WARNING

Misuse of equipment can cause death or serious injury. Read and understand operator's manual and all other safety instructions before use.

Follow these guidelines before operating any jobsite equipment:

- Complete proper training.
- Read and understand operator's manual before using equipment.
- Wear personal protective equipment.
- In the US or Canada, call 811 (US) or 888-258-0808 (US and Canada). Also contact any local utilities that do not participate in the One-Call service. In countries that do not have a One-Call service, contact all local utility companies to have underground utilities located.
- Classify jobsite based on its hazards and use correct tools and machinery, safety equipment, and work methods for jobsite.
- Mark jobsite clearly and keep spectators away.
- Review jobsite hazards, safety and emergency procedures, and individual responsibilities with all personnel before work begins.
- Fully inspect equipment before operating. Repair or replace any worn or damaged parts. Replace missing or damaged safety shields and safety alert signs. Contact your Ditch Witch dealer for assistance.
- Replace missing or damaged safety signs.
- Use equipment carefully per the instructions in this manual. Stop operation and investigate anything that does not look or feel right.
- Contact your equipment dealer if you have any questions about operation, maintenance, or equipment use.

Safety Alerts

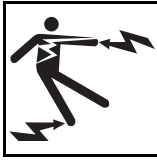

⚠ DANGER Electrical equipment. Contact will cause death or serious injury. Read and understand operator's manual. Know emergency procedures.

To help avoid injury:

- Check that equipment is in good condition and that test leads are clean and have no cracked insulation.
- Only connect transmitter to live utility when using live power adapter.



⚠ WARNING Lithium cell batteries. Fire or explosion can cause death or serious injury. Follow proper care, handling, and charging precautions. See operator's manual.

To help avoid injury:

- Turn off equipment and remove accessories before opening battery compartment.
- Only charge with approved battery charger.
- Do not crush, heat or incinerate, short circuit, dismantle, or immerse in fluid.
- Use proper disposal.
- Follow proper shipping procedures for Class 9 batteries.

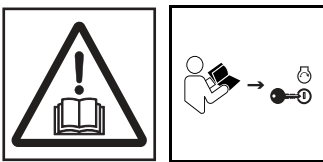

⚠ WARNING Misuse of equipment can cause death or serious injury. Read and understand operator's manual and all other safety instructions before use.

To help avoid injury: Only operate away from explosive devices or blasting operations.



⚠ WARNING Moving traffic - hazardous situation. Death or serious injury could result. Avoid moving vehicles, wear high-visibility clothing, post appropriate warning signs.

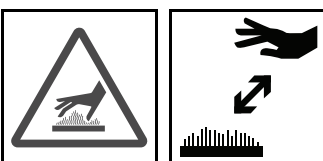

⚠ CAUTION Hot batteries. Contact can cause injury. Only touch when cool or wear gloves.

Prepare

Chapter Contents

	<p>See "Safety" for additional precautions.</p> <p>Wear proper personal protective equipment.</p>
---	---

Prepare Jobsite 12

- Review Job Plan 12
- Select Start and End Points 12
- Identify Hazards 13
- Locate Utilities 13
- Classify Jobsite 14
- Arrange for Traffic Control 15

Prepare Operator 16

System Requirements 17

- Esri 17
- Locating 17
- Point Navigation GNSS 17

Prepare Jobsite



⚠ WARNING

Underground utilities. Contact can cause death or serious injury. Locate and verify underground utilities before digging or drilling.

To help avoid injury:

- Expose lines by careful hand digging or soft excavation before operating equipment. Use appropriate equipment and procedures for exposing utility lines.
- Classify jobsite and follow precautions based on classification.
- Follow local regulations for digging near utilities.

A successful job begins before working. The first step in planning is reviewing information already available about the job and jobsite.

Review Job Plan

Review blueprints or other plans. Check for information about existing or planned structures, elevations, or proposed work that may be taking place at the same time.

Select Start and End Points

Select one end to use as a starting point. Consider the following when selecting a starting point:

Slope

Equipment should be parked on a level site. Consider how slope will affect setup and operation. Assess the risks on each slope to determine if factors affecting risks create an unsafe condition for working.

Space

Check that starting and ending points allow enough space for working.

Comfort

Consider shade, wind, fumes, and other site features.

Identify Hazards

Inspect jobsite before transporting equipment. Check for the following:

- overall grade or slope
- changes in elevation such as hills or open trenches
- obstacles such as buildings, railroad crossings, or streams
- signs of utilities
 - “buried utility” notices
 - gas or water meters
 - drop boxes
 - manhole covers
 - utility facilities without overhead lines
 - junction boxes
 - light poles
 - sunken ground
- traffic
- access
- soil type and condition
- loose material such as fencing or cable

Locate Utilities

Notify One-Call Services

Mark proposed path with white paint and have underground utilities located before working.

- In the US or Canada, call 811 (US) or 888-258-0808 (US and Canada). Also contact any local utilities that do not participate in the One-Call service.
- In countries that do not have a One-Call service, contact all local utility companies to have underground utilities located.

Verify Underground Utilities

Have an experienced locating equipment operator sweep area within 20’ (6 m) to each side of proposed excavation to verify previously marked line and cable locations. Mark location of all buried utilities and obstructions.

Locate Overhead Lines

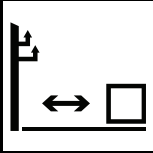
⚠ DANGER Overhead electrical lines. Contact will cause death or serious injury. Know location of lines. Stay away.

Note location and height of all overhead lines in jobsite and ensure that equipment maintains proper distance from live lines.

Classify Jobsite

Select a Classification

Jobsites are classified according to underground hazards present, not by line being installed. Jobsite may have more than one classification.

If working . . .	then classify jobsite as . . .
within 10' (3m) of a buried electric line	electric
within 10' (3m) of a natural gas line	natural gas
in concrete, sand, or granite which is capable of producing crystalline silica dust	crystalline silica dust
within 10' (3m) of any other hazard	other

Classify jobsite as electric if jobsite is in question or if the possibility of unmarked electric utilities exists.

Apply Precautions



⚠ WARNING Underground utilities. Contact can cause death or serious injury. Locate and verify underground utilities before digging or drilling.

Once classified, precautions appropriate for jobsite must be taken. Follow US Department of Labor regulations on excavating and trenching (Part 1926, Subpart P) and other similar regulations.

Electric Jobsite Precautions

Use one or both of these methods:

- Expose line by careful hand digging or soft excavation.
- Have service shut down while work is in progress. Have electric company test lines before returning them to service.

Natural Gas Jobsite Precautions

Position equipment upwind from gas lines and use one or both of these methods:

- Expose line by careful hand digging or soft excavation.
- Have service shut down while work is in progress. Have gas company test lines before returning them to service.

Crystalline Dust Jobsite Precautions

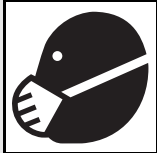
		⚠ WARNING Silica dust. Exposure can cause lung disease or cancer. Use breathing protection.
---	---	--

Crystalline silica dust is a naturally occurring substance found in soil, sand, concrete, granite, and quartz.

To reduce exposure when cutting, drilling, or working these materials:

- Use water spray or other means to control dust.
- Refer to US Occupational Safety and Health Administration (OSHA) guidelines or other applicable regulating guidelines for appropriate breathing protection or dust control methods.

Other Jobsite Precautions

You may need to use different methods to safely avoid other underground hazards. Talk with those knowledgeable about hazards present at each site to determine which precautions should be taken or if job should be attempted.

Clear objects such as landscaping fabric, cable, and wire from the work area. These objects may be underground or partially buried.

Arrange for Traffic Control

Vehicle and pedestrian traffic must be a safe distance from equipment. Evaluate jobsite and allow an appropriate buffer zone around equipment. If working near a road or other traffic area, contact local authorities about safety procedures and regulations.

Prepare Operator



⚠ WARNING Jobsite hazards. Exposure can cause death or serious injury. Use correct equipment and work methods. Use and maintain appropriate safety equipment.

To help avoid injury:

- Wear personal protective equipment including hard hat, safety eye wear, foot protection, hearing protection, and gloves (except when near rotating equipment).
- Remove jewelry.
- Wear close-fitting, high visibility clothing.
- Have other personal protective equipment, such as insulated boots and gloves, breathing protection, and face shield, etc. available for use depending on jobsite hazards or requirements.

Follow these guidelines before operating any jobsite equipment:

- Complete proper training and read operator's manual before using equipment.
- Plan for emergency services. Have the telephone numbers for local emergency and medical facilities on hand. Check that you will have access to a telephone.
- Review jobsite hazards, safety and emergency procedures, and individual responsibilities with all personnel before work begins. Safety videos are available from your Ditch Witch dealer or at www.ditchwitch.com/safety. Safety Data Sheets (SDS) are available at www.ditchwitch.com/support.
- Use equipment carefully. Stop operation and investigate anything that does not look or feel right.

System Requirements

Operating System

UtiliView requires iOS 14 or Android 5.

Esri

An Esri account with access to ArcGIS Pro is required.

Locating

A UtiliGuard 2 Standard with 1.0.11-34 radio, UtiliGuard 2 Advanced with 1.0.11-34 radio, or UtiliGuard 2 RTK must be used to log points and lines.

Point Navigation GNSS

IMPORTANT: GNSS accuracy depends on the accuracy of the device being used. See GNSS device specifications to determine accuracy.

Point Navigation can be used with or without a UtiliGuard 2 receiver. If a UtiliGuard 2 receiver is paired to the smart device, Point Navigation will use the higher accuracy GNSS antenna and corrections service, if applicable. If a UtiliGuard 2 receiver is not paired to the mobile device, the mobile device can use its native GNSS antenna.

Controls

Chapter Contents

Maps Menu	20
Swipe Options and New Map	21
Settings Menu	22
Tabs	23
Map	25
Attachment	27
Point Navigation	28
Correction Services	30
Swipe Options and New Service	31
Corrections	32
Connected Device	33

Maps Menu



- 1. Settings
- 2. Esri maps

- 3. New Esri map

Item	Description	IMPORTANT
1. Settings	To access general settings, press.	
2. Esri maps	List of existing Esri maps.	
3. New Esri map	To set up a new Esri map, press.	

Swipe Options and New Map

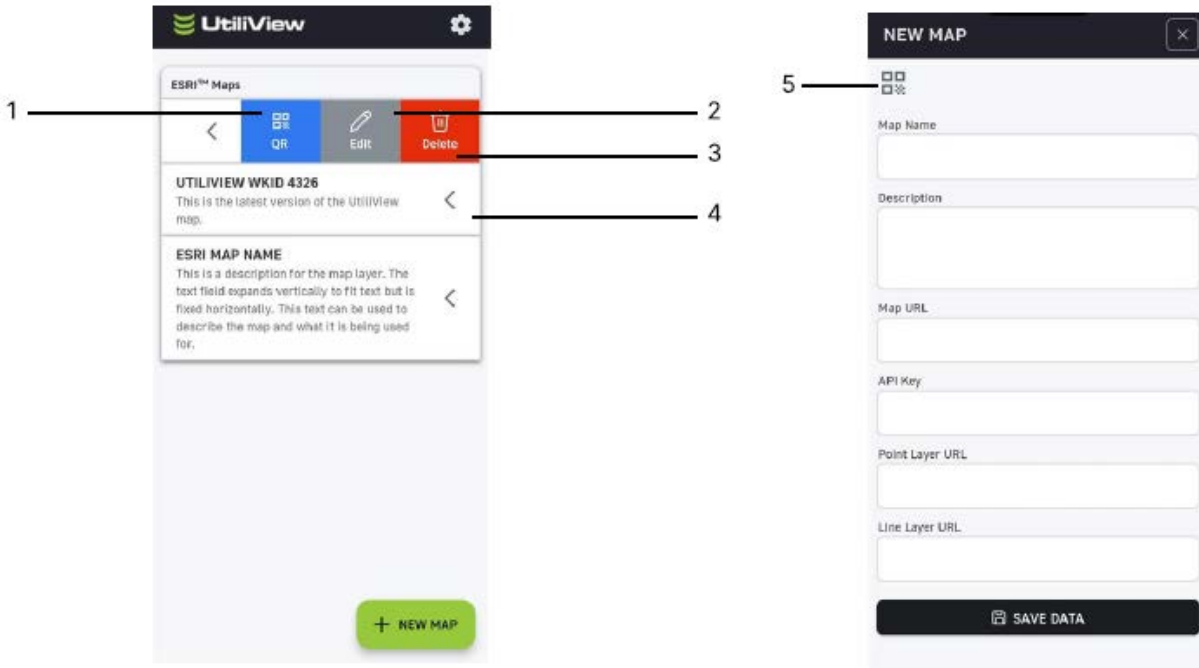

- 1. QR display
- 2. Edit
- 3. Delete
- 4. Swipe
- 5. QR scan

Item	Description	IMPORTANT
1. QR display	To view QR code to share the map, press.	
2. Edit	To edit the map, press.	
3. Delete	To delete the map from this device, press.	
4. Swipe	To see details about a job, swipe left.	
5. QR scan	To enter another map's data, press.	

Settings Menu

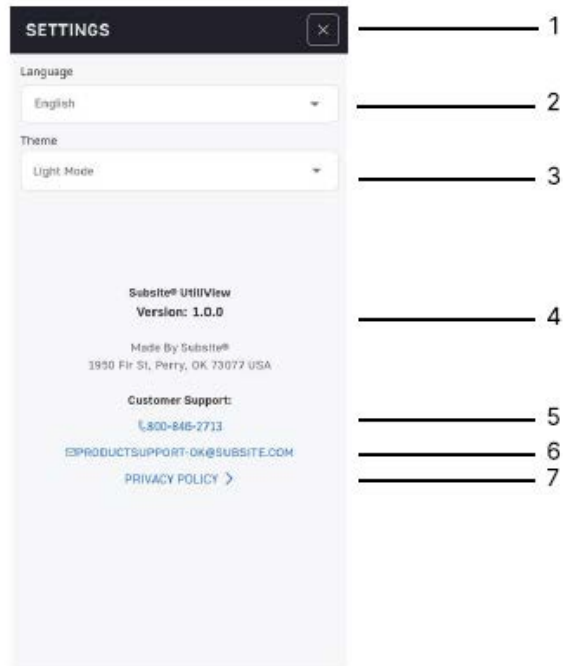

- | | |
|-------------|----------------------------------|
| 1. Close | 5. Customer support phone number |
| 2. Language | 6. Customer support email |
| 3. Theme | 7. Privacy policy |
| 4. Version | |

Item	Description	IMPORTANT
1. Close	To close settings and return to the layer menu, press.	
2. Language	To change language, press.	
3. Theme	To change the theme, press.	Options are Dark, Light, or System.
4. Version	Displays the version of the application.	
5. Customer support phone number	Displays phone number for support.	
6. Customer support email	Displays email for support.	
7. Privacy policy	To see our privacy policy, press.	

Tabs

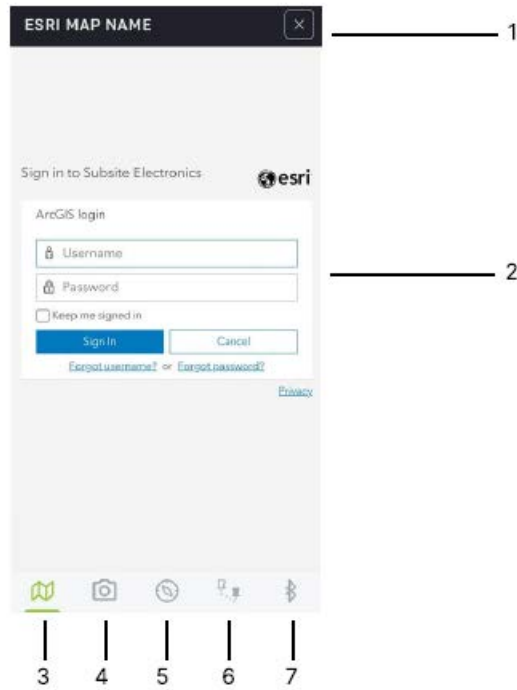

- 1. Close
- 2. Esri map web view
- 3. Map
- 4. Attachment
- 5. Point Navigation
- 6. Correction services
- 7. Connections

Item	Description	IMPORTANT
1. Close	To close Esri map and return to the map menu, press.	
2. Esri map web view	To open web view for Esri map, press and enter Esri credentials.	
3. Map	To display the Esri map, press.	
4. Attachment	To attach an image to a log point, press and enter the point ID.	
5. Point Navigation	To navigate back to a log point, press and enter the point ID.	

Tabs

Item	Description	IMPORTANT
6. Correction services	To set up and connect to a correction service, press.	
7. Connections	To connect to a UtiliGuard receiver, press.	

Map

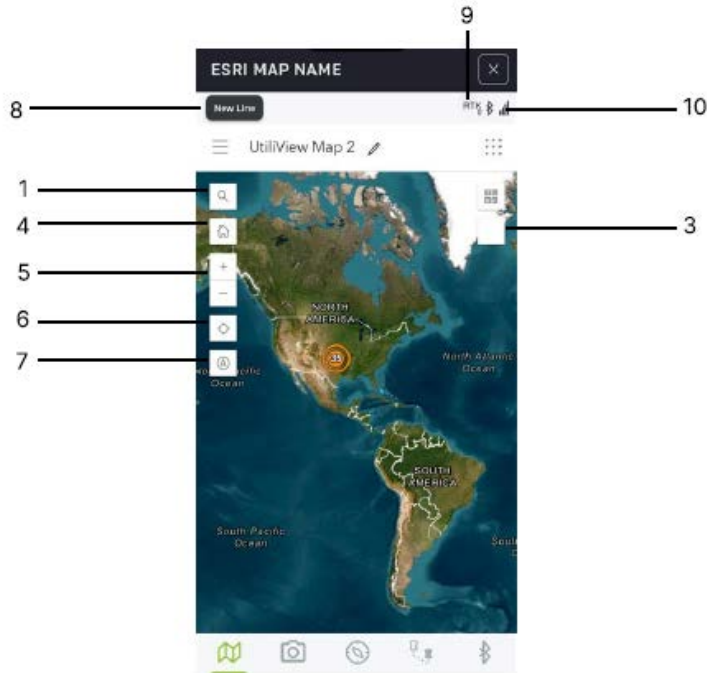

- 1. Search
- 2. Basemap options
- 3. Layer list
- 4. Home
- 5. Zoom
- 6. Current location
- 7. Auto-refresh location
- 8. New line
- 9. Corrections count
- 10. Bluetooth signal strength

Item	Description	IMPORTANT
1. Search	To search for locations within Esri, press.	
2. Basemap options	To change the style of the basemap, press.	
3. Layer list	To change visibility of layers, press.	
4. Home	To return to the default view, press.	
5. Zoom	To zoom in or out, press.	
6. Current location	To display the current location of the device, press.	

Item	Description	IMPORTANT
7. Auto-refresh location	To updates current location every second, press. To stop automatic location updates, press again.	
8. New line	To end current line and start a new one, press.	
9. Corrections count	Displays NTRIP RTK corrections packet count.	
10. Bluetooth signal strength	Indicates the strength of the Bluetooth connection.	

Attachment



1. Log point ID field

2. Attach image

Item	Description	IMPORTANT
1. Log point ID field	To find a log point on the map, enter log point ID.	
2. Attach image	To attach a photo or image from the library, press.	

Point Navigation

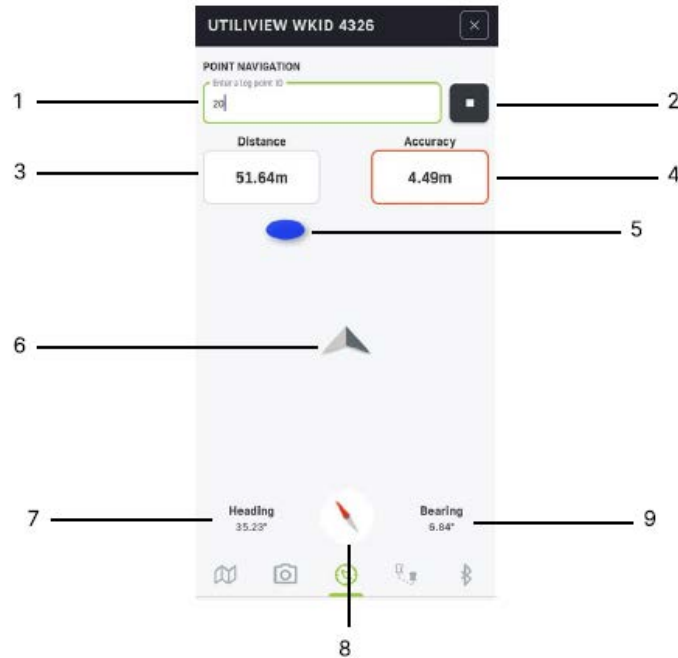

- | | |
|-----------------------|--------------------|
| 1. Log point ID field | 6. Device position |
| 2. Start/Stop | 7. Heading |
| 3. Distance | 8. Compass |
| 4. Accuracy | 9. Bearing |
| 5. Log point | |

Item	Description	IMPORTANT
1. Log point ID field	To find a log point on the map, enter log point ID.	
2. Start/Stop	To begin and end navigation, press.	
3. Distance	Displays distance to log point.	
4. Accuracy	Displays GNSS accuracy.	
5. Log point	Indicates log point destination.	
6. Device position	Represents device position.	

Item	Description	IMPORTANT
7. Heading	Displays the compass direction the Android or iOS device is pointing.	
8. Compass	Displays the cardinal directions and points North.	
9. Bearing	Displays the angle from North to the log point.	

Correction Services

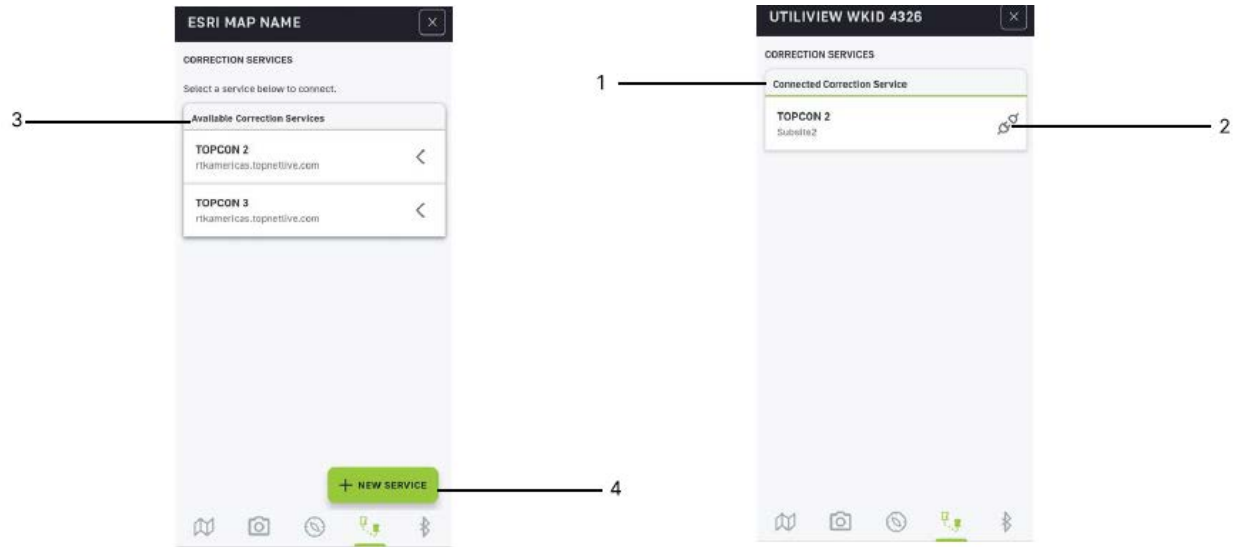

- | | |
|-----------------------------------|----------------------------------|
| 1. Connected correction service | 3. Available correction services |
| 2. Disconnect corrections service | 4. New corrections service |

Item	Description	IMPORTANT
1. Connected correction service	Indicates the correction service currently connected.	
2. Disconnect corrections service	To disconnect service, press.	
3. Available correction services	Displays corrections services not being used.	
4. New corrections service	To add new corrections service, press.	

Swipe Options and New Service



- 1. Edit
- 2. Delete
- 3. Swipe
- 4. QR display
- 5. QR scan

Item	Description	IMPORTANT
1. Edit	To edit the corrections service, press.	
2. Delete	To delete the corrections service, press.	
3. Swipe	To see options, swipe left.	
4. QR display	To view QR code to share the service data, press.	
5. QR scan	To enter another service's data, press.	

Connections

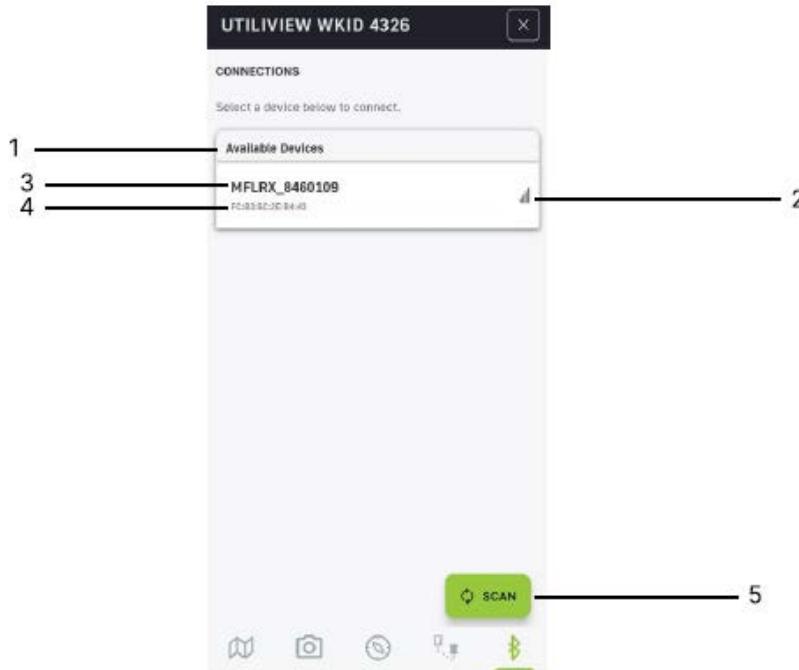

- | | |
|------------------------------|-----------------------|
| 1. Available devices | 4. Device MAC address |
| 2. Bluetooth signal strength | 5. Scan |
| 3. Device name | |

Item	Description	IMPORTANT
1. Available devices	Available Bluetooth devices.	
2. Bluetooth signal strength	Displays signal strength of the Bluetooth device.	
3. Device name	Displays the name of the Bluetooth device.	
4. Device MAC address	Displays the unique MAC address of the Bluetooth device.	
5. Scan	To rescan for Bluetooth devices, press.	

Connected Device



1. Connected device information

2. Disconnect service

Item	Description	IMPORTANT
1. Connected device information	To view information about the connected Bluetooth device, press.	
2. Disconnect device	To disconnect the Bluetooth device, press.	

Operate

Chapter Contents



For additional precautions, see "Safety" chapter.

Set Up Esri Map	36
• Layers	36
• New Map	36
• API Key	37
• URLs	
System Operation	39

Set Up

Before starting this process, create a secure document (text document or spreadsheet) to store map setup data. Ensure this document can be shared with a mobile device for UtiliView setup.

Layers

1. Go to <https://www.subsite.com/software/software-updates/#utiliguard> and download the **UtiliView Fields Template.ppkx** file.
2. Open the file in ArcGIS Pro.
3. Click **Share as Web Layer** from the Share tab.
4. Name it "UtiliView Layer Group."
5. Click **Publish**. A service definition document will also be created in your online account but it will not be needed.

New Map

1. Sign in to your ArcGIS online account and go to **Map**.
2. Select **Basemap** and then **Imagery Hybrid**.
3. Click **Layers** and then **Add**.
4. Find "UtiliView Layer Group" and add it to the map.
5. Click the back button on the Layers panel and then click the dropdown on "UtiliView Layer Group."
6. Select **Subsite UtiliView Points** and its Properties panel will open on the right.
7. Scroll down on the Properties panel and turn on **Automatically refresh layer** and then set the interval to **0.1** minutes.
8. Select Aggregation tab and enable aggregation with the **Clustering** option selected.
9. Select **Subsite UtiliView Lines** from the Layers panel on the left and its Properties panel will open on the right.
10. Scroll down on the Properties panel and turn on **Automatically refresh layer** and then set the interval to **0.1** minutes.
11. Ensure you are signed in to your Esri account, then select the **Save and Open** button, then **Save as**.
12. Title it "UtiliView Map" and select **Save**.
13. Go to Content.
14. Click on "UtiliView Layer Group" and Settings.
15. Scroll down to **Feature Layer (hosted)** and select **Enable editing**. Click **Save**.

API Key

1. Go to **Content**.
2. Select **New item**.
3. Select **Developer credentials**.
4. Select the radio button for **API key credentials** and press **Next**.
5. Set the expiration date for one year and press **Next**. (You must renew this annually.)
6. Turn on all location services and press **Next**.
7. To grant item access, select **Browse items**, select UtiliView Layer Group, select UtiliView Map, and then press **Add items**.
8. Enter "API Key for UtiliView" as the title and press **Next**.
9. Review the summary and press **Next**.
10. Select "Generate the API key and go to item details page. I am ready to copy and save the key" and press **Next**.
11. Press copy button and paste this into a secure document that you can access later from your mobile device.
12. Press **Close**.

URLs

1. Go to **Content**.
2. Select **UtiliView Map** and open it in Map Viewer.
3. Copy the URL and paste it into your secure document along with your API key.
4. Go back to **Content**.
5. Select **UtiliView Layer Group**.
6. Select **Subsite UtiliView Points**.
7. From the right pane, copy the URL and paste it into your secure document.
8. Navigate back to **UtiliView Layer Group**.
9. Select **Subsite UtiliView Lines**.
10. From the right pane, copy the URL and paste it into your secure document.

Your secure document should contain the following:

- Map URL
- API Key
- Point Layer URL
- Line Layer URL
- Esri user name and password that will be used in the field (optional)

Once this information has been entered into the initial mobile device, QR code sharing can be used to copy the data to the other mobile devices.

Esri map set up is now complete.

System Operation

1. Click **NEW MAP**, then enter a name, description, and the Esri information from the Esri Map Setup. For initial setup on or first mobile device, share a secure setup document with the mobile device.

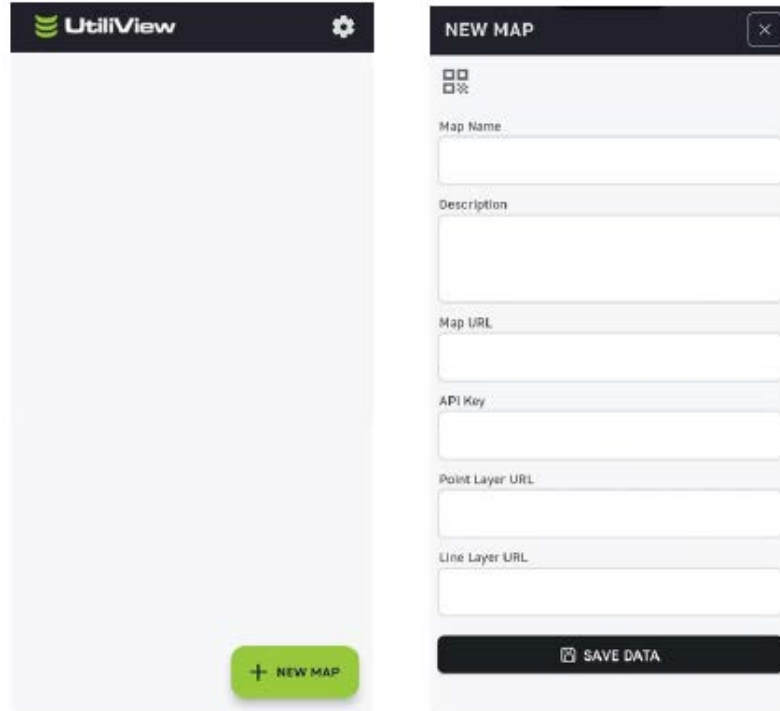

2. Click on the map you created to open it and then sign into your Esri account. Accept the location permission request.

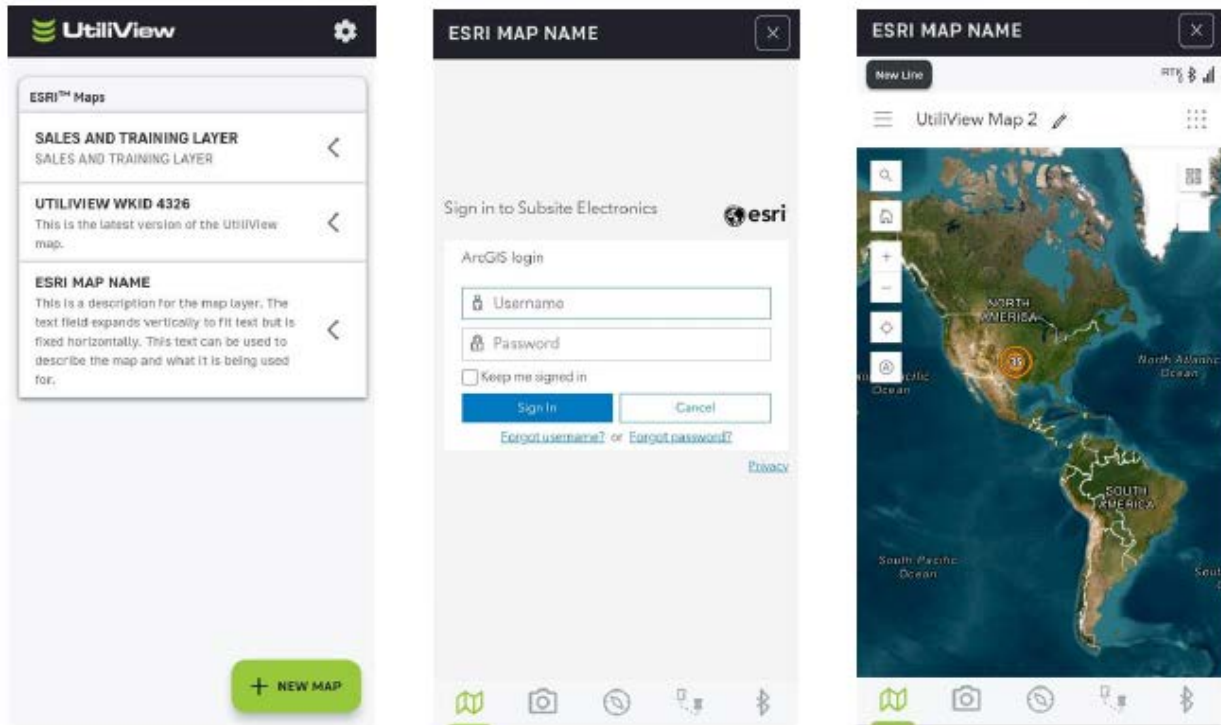

3. Click the Bluetooth tab, scan for your receiver, and then select it to connect. Accept the Bluetooth permission request.

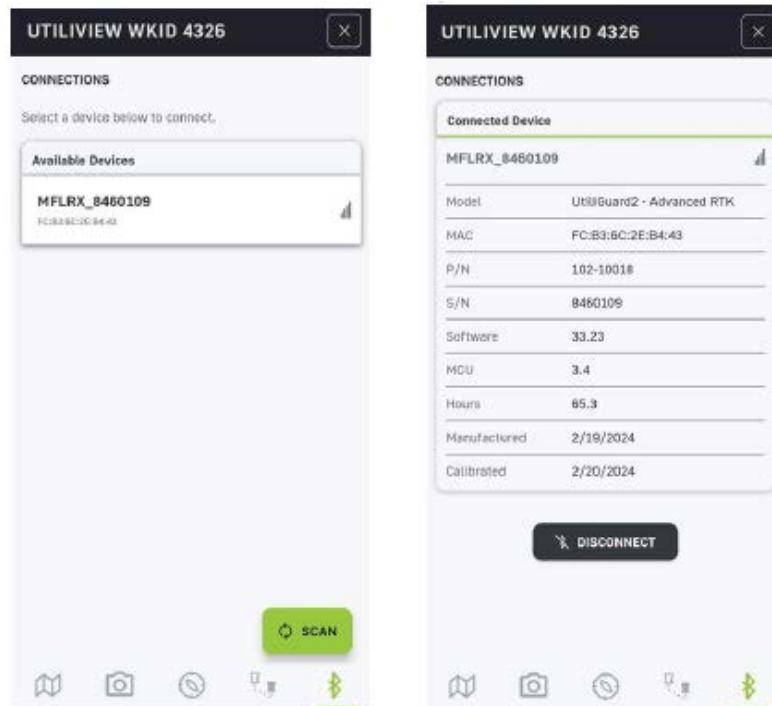

- If you are using a UTG2 RTK receiver and want to set up a corrections service for the highest accuracy, select the **Corrections** tab. Click **NEW SERVICE**, fill out the information from your service provider, click **save** and then select it from the list to connect.

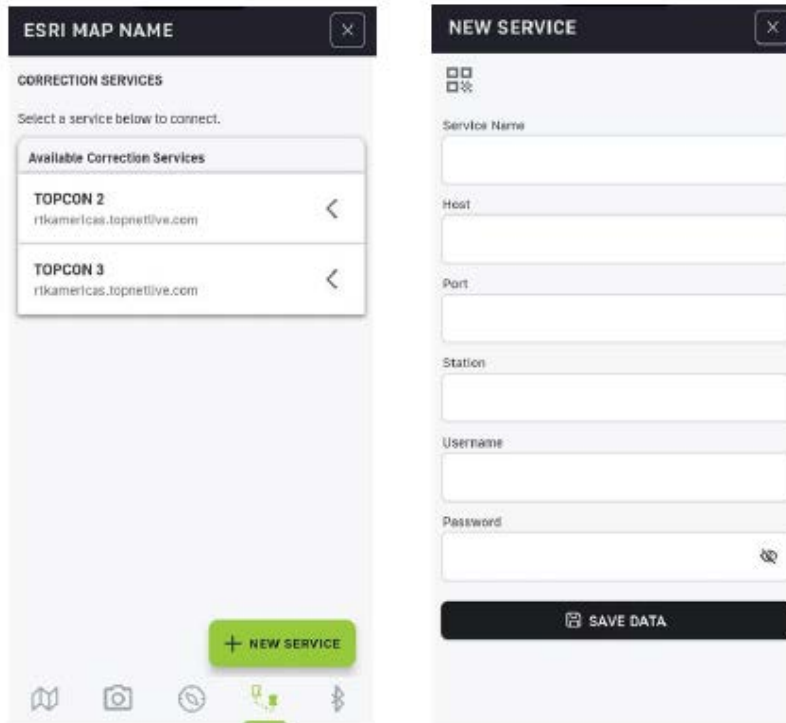

- When you log a point with the receiver, it will be sent to the Esri map automatically.



6. If desired, attach a picture to a log point. Tap on the point in the Map tab to see its ID number. Enter that number on the Attachment tab and press the camera button.

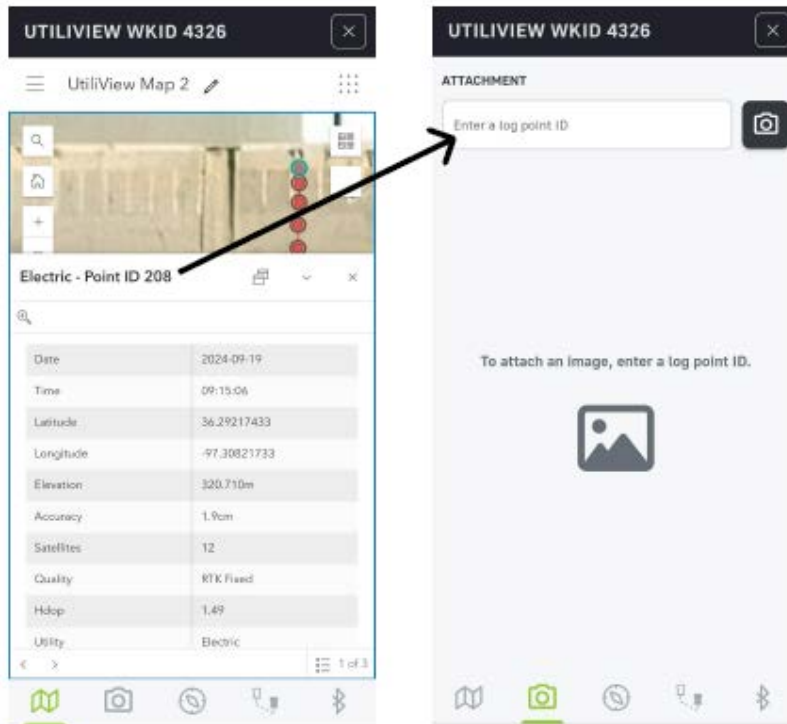

7. To find a log point again, press on it in the Map tab to see its ID number. Enter that number on the Point Navigation tab and press the start button to begin navigation.

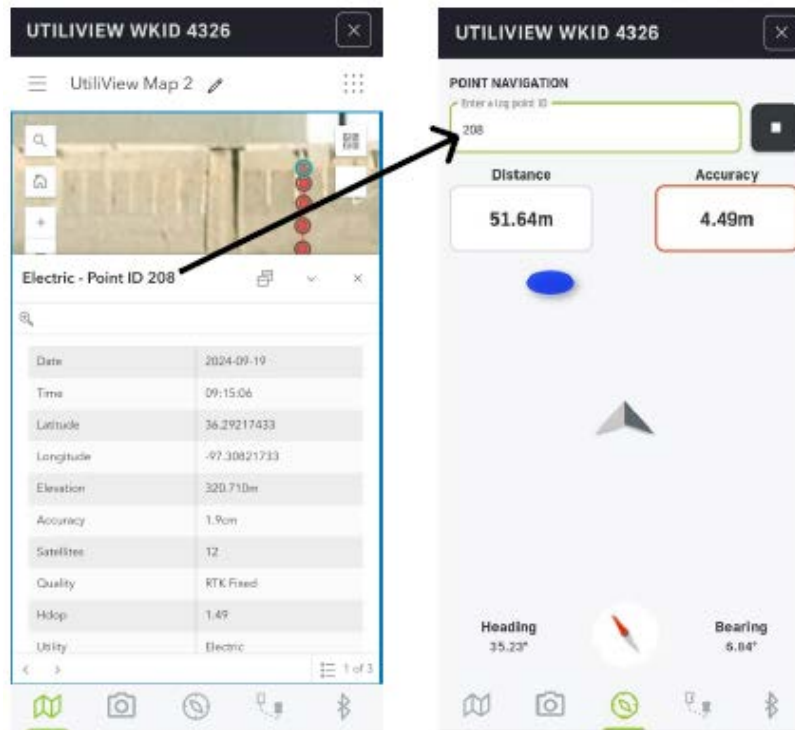

Support

Procedure

Notify your dealer immediately of any malfunction or failure of Subsite equipment.

Always give model, serial number, and approximate date of your equipment purchase. This information should be recorded and placed on file by the owner at the time of purchase.

Return damaged parts to dealer for inspection and warranty consideration if in warranty time frame.

All repairs must be done by an authorized Subsite repair facility. Repairs done elsewhere will void warranty.

Resources

Publications

Contact your dealer for publications and videos covering safety, operation, maintenance, and repair of your equipment.

Training

For information about on-site individualized training, contact your dealer.

Warranty

Electronics Limited Warranty Policy

Subject to the limitation and exclusions herein, free replacement parts and labor will be provided when a unit fails due to a defect in material or workmanship within one (1) year of first commercial use. (See exceptions below for specific products.) Defects shall be determined through inspection by Manufacturer or authorized repair centers. An inspection must occur within thirty (30) days of the date of failure of the product or part by Manufacturer or its authorized repair facility. Manufacturer will provide the location of its inspection facilities or its nearest authorized dealer upon inquiry. Manufacturer reserves the right to supply remanufactured replacement parts under this warranty as it deems appropriate. Each warranty repair carries the remainder of the factory warranty or ninety (90) days, whichever is longer, for all repaired components and labor.

Product Warranty Exceptions:

- HDD guidance beacons, Locate Beacons and Accessories, carry a six (6) month warranty.
- HDD guidance beacons, M-Series and T-Series, carry a three (3) year 750 hour warranty.
- All Used (Cosmetic) Electronics products sold from Manufacturer carry a six (6) month warranty from date of sale to dealer

Exclusions from Product Warranty

- All defects or damages caused by misuse, abuse, improper installation, alteration, neglect, modification, lack of maintenance, or uses
- All defects or damages caused by misuse, abuse, improper installation, alteration, neglect, modification, lack of maintenance, or uses other than those for which the products were intended.
- All defects, damages, or injuries caused by improper training, operation, or servicing of products in a manner inconsistent with manufacturer's recommendations.
- All batteries, which are considered consumable and therefore not covered under this warranty.
- All damaged plastics are considered to be the result of misuse or neglect unless Manufacturer has determined otherwise.
- All repairs or attempted repairs by non-certified repair facilities or personnel will void the warranty.
- All incoming duties and freight charges.
- Manufacturer reserves the right to make changes in design and/or improvements to products from time to time, and user understands that Manufacturer shall have no obligation to upgrade any previously manufactured product to include any such changes.
- In no event shall Manufacturer or its agents, assigns, or parent company be liable for any indirect, special, incidental, or consequential damages or for any cover, loss of information, profit, revenue, or use based upon any claim by user for breach of warranty, breach of contract, negligence, strict liability or any other legal theory. In no event shall Manufacturer liability exceed the amount user has paid for the Manufacturer product.
- Manufacturer will not be responsible for loss of accessories or loss or erasure of data storage media.
- Should it be determined that applicable law prohibits enforcement of any provision of this Warranty Policy, then to the extent it is necessary to comply with the applicable law, this Warranty Policy shall be deemed amended.
- This Warranty Policy shall be the entire agreement between Manufacturer and the Purchaser. Any statements that purport to be different than or modify or expand the terms set forth in this written policy are not effective for any purpose. ANY IMPLIED WARRANTIES, INCLUDING WARRANTIES OF MERCHANTABILITY AND FITNESS FOR A PARTICULAR USE ARE EXPRESSLY DISCLAIMED. IN NO EVENT SHALL SUBSITE, THE CHARLES MACHINE WORKS, INC., OR ANY AUTHORIZED SERVICING AUTHORITY BE RESPONSIBLE FOR ANY LOSSES, INCLUDING CONSEQUENTIAL AND INCIDENTAL DAMAGES, EXCEPT AS EXPRESSLY PROVIDED HEREIN.

Service and Repair

Units repaired at Manufacturer's location or an authorized service center will carry a 90-day warranty on all replaced components/parts and labor commencing on the date of repair.

HDD guidance beacons, M-Series and T-Series repairs: If a lower assembly is replaced on any T-Series beacons, the 750-hour count will start over at zero (0) hours. The warranty years will continue from date of product registration.

M-Series beacons: M-Series beacons are not repairable. Warranty assessments can only be done at an authorized Subsite repair center. If found to be defective, Authorized Service Center may replace with new beacon.

M-Series and T-Series beacons that are past the three (3) year warranty will have a 90-day repair warranty.

Extended Warranty

Consult your local Subsite dealer for extended warranty options.

Warranty Details

For information regarding this warranty policy, contact Subsite Product Support at (800)846-2713 ext. 1; mail us at 1950 W. Fir, Perry, OK 73077; or contact your local dealer.

April 2021

